

Paul Harris Home

\$5 Million Restoration & Endowment Campaign
Jean and Paul Harris Home Foundation, Inc.
A Strategic Partner with Rotary International

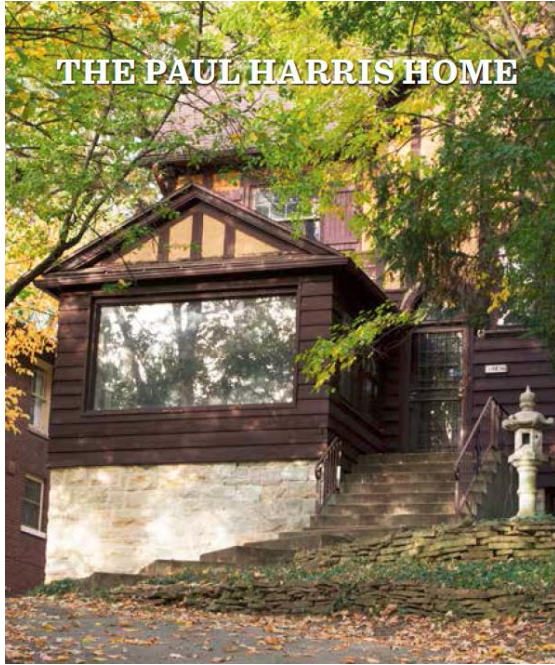
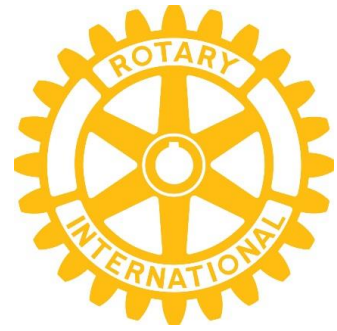

Support the Restoration

Donations for the Paul & Jean Harris Foundation

Website:

www.paulharrishome.org

Wire transfer:

Contact Robert Knuepfer,
rknuepfer@rotaryone.club

Mail:

Please make checks payable in U.S. funds to:
Paul and Jean Harris Home Foundation
c/o Andrea Luehmann, Treasurer
525 W. Monroe Street, Suite 2360 Chicago, IL 60661
USA

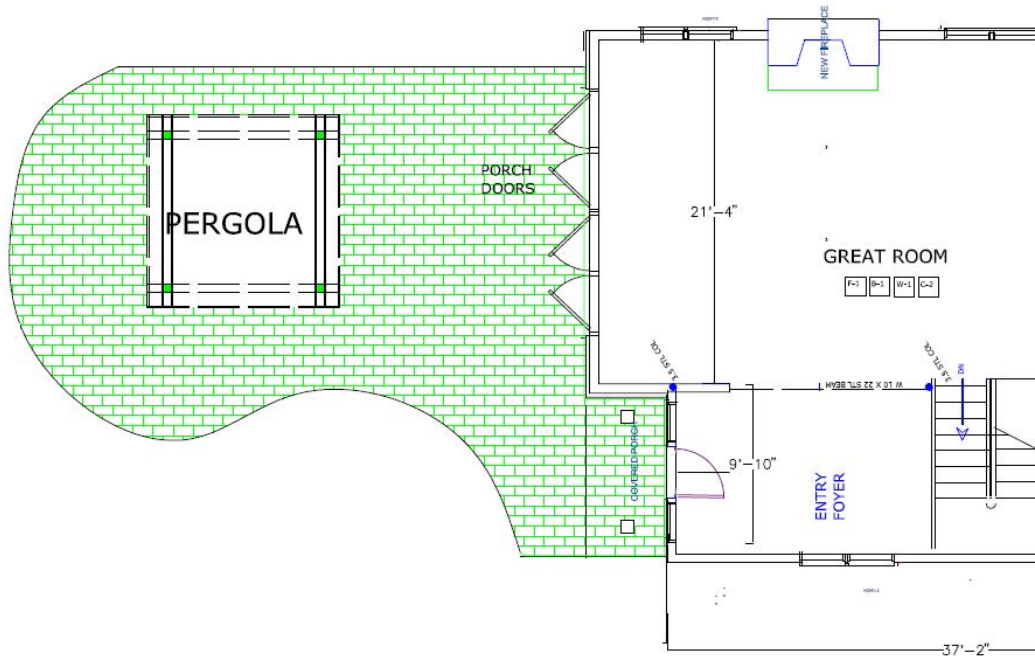

Commemorative Bricks & Recognition

Donors of \$1,000 US or more are recognized with an engraved brick on the patio adjacent to the great room (addition to the home).

Paul Harris Home



I would like to:

make a gift now

make a pledge, payable over time (1-5 years).

DONOR INFORMATION

This is my work home address.

First Name

Last Name

--	--

Street Address

Apt. #

--

Municipality

Province

Postage Code

--	--	--

Phone

Email

--	--

I would like to make a gift or pledge in the amount of (US Dollars):

<input type="checkbox"/>
<input type="checkbox"/>
<input type="checkbox"/>

\$500,000

\$50,000

\$5,000

<input type="checkbox"/>
<input type="checkbox"/>
<input type="checkbox"/>

\$250,000

\$25,000

\$2,500

<input type="checkbox"/>
<input type="checkbox"/>
<input type="checkbox"/>

\$100,000

\$10,000

Other:\$ _____

I am enclosing a check in the amount of \$ _____

(Please make checks payable in US funds to Paul and Jean Harris Home Foundation.)

FOR PLEDGES

I would like to pay my pledge over _____ years (1-5), beginning on _____ (dd/mm/yy).

I would like to make payments (Please check): Annually Bi-annually Quarterly

My initial pledge payment is enclosed.

Or

Please invoice me for my initial pledge payment.

Donor Signature _____

Paul and Jean Harris Home Foundation c/o Andrea Luehmann, Treasurer
525 W. Monroe Street, Suite 2360 Chicago, IL 60661 USA